

TR 24

CONJUNTO RESIDENCIAL

Planta / Floor: 0

Escaleras / Stairs: 3

Puerta / Door: A

Sup. útil / Useful surface: 63,65 m²

Terraza / Terrace area: 11,60 m²

Sup. const. / Built surface: 90,20 m²



GROUND FLOOR

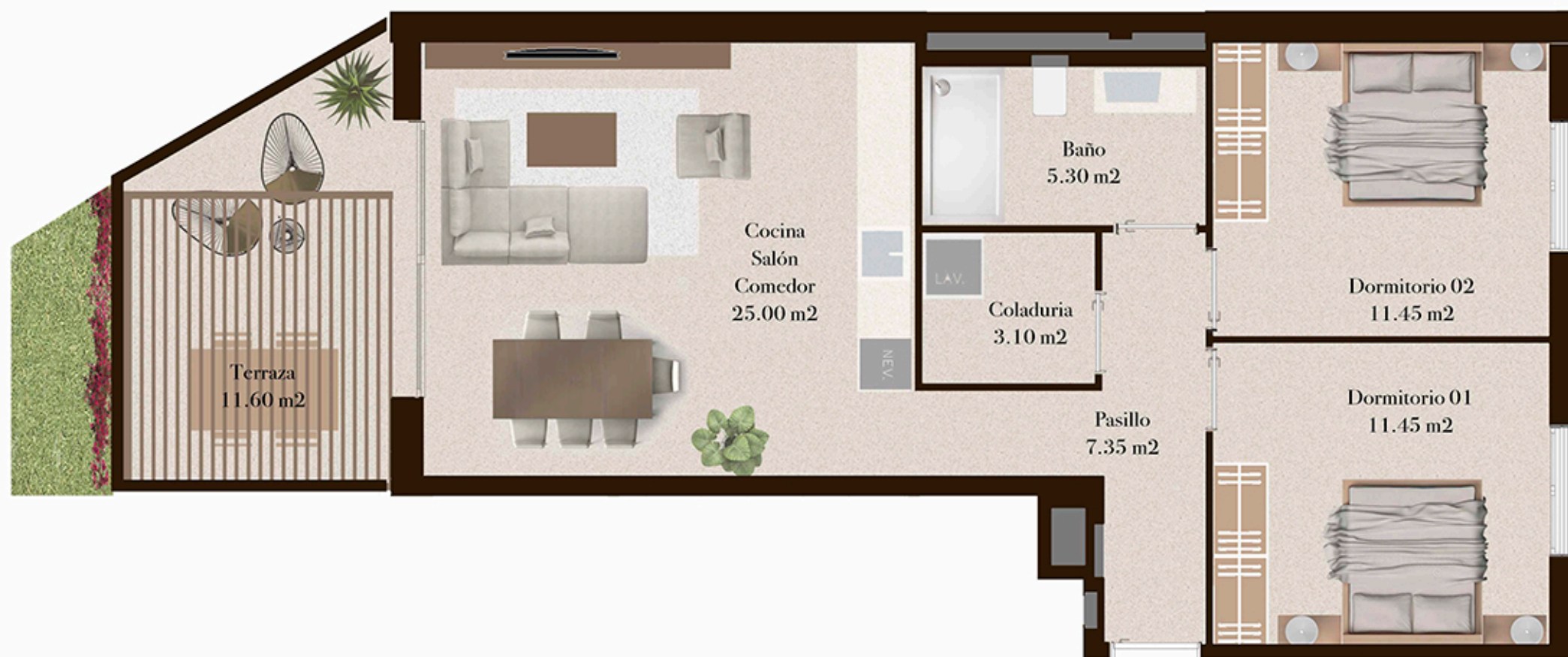

E 0 1 2 3 4 5 10 m