

TR 24

CONJUNTO RESIDENCIAL

Planta / Floor: 0
Escaleras / Stairs: 3
Puerta / Door: B

Sup. útil / Useful surface: 39,05 m²
Terraza / Terrace area: 17,40 m²
Sup. const. / Built surface: 64,50 m²

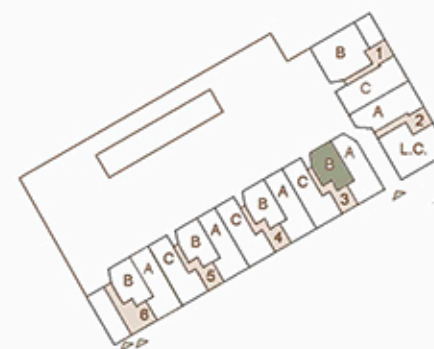

GROUND FLOOR



E 0 1 2 3 4 5 10 m