

TR 24

CONJUNTO RESIDENCIAL

Planta / Floor: 1
 Escaleras / Stairs: 1
 Puerta / Door: C

Sup. útil / Useful surface: 56,00 m²
 Terraza / Terrace area: 7,40 m²
 Sup. const. / Built surface: 75,80 m²

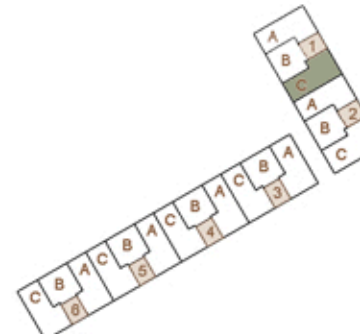

Ⓧ FIRST FLOOR

