

TR 24

CONJUNTO RESIDENCIAL

Planta / Floor: 1
Escaleras / Stairs: 6
Puerta / Door: C

Sup. útil / Useful surface: 57,30 m²
Terraza / Terrace area: 7,30 m²
Sup. const. / Built surface: 77,85 m²

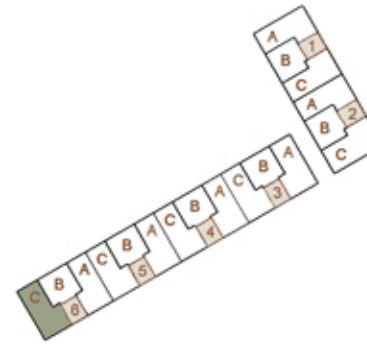

FIRST FLOOR



E 0 1 2 3 4 5 10 m