

# TR 24

CONJUNTO RESIDENCIAL

Planta / Floor: 2  
Escaleras / Stairs: 2  
Puerta / Door: A

Sup. útil / Useful surface: 56,50 m<sup>2</sup>  
Terraza / Terrace area: 7,40 m<sup>2</sup>  
Sup. const. / Built surface: 77,90 m<sup>2</sup>

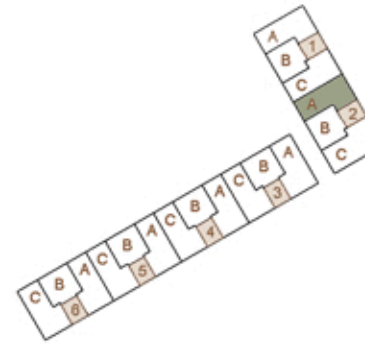

Ⓧ FIRST FLOOR

